

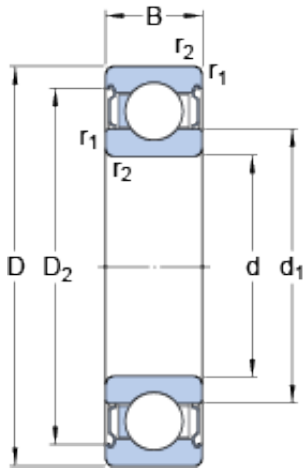

China 608rs Bearing Supplier



6305-2z/Va228 Bearing 2D drawings and 3D CAD models

SKF High Temperature Bearing 6305-2z/Va228 for SKF High Temperature Bearing

Bearing No. 6305-2z/Va228

Size	62x25x17 mm
Bore Diameter	62 mm
Outer Diameter	25 mm
Width	17 mm
d	25 mm
D	62 mm
B	17 mm
d ₁	36.6 mm
D ₂	52.7 mm
r _{1,2} - min.	1.1 mm
d _a - min.	32 mm
d _a - max.	36.5 mm
D _a - max.	55 mm
r _a - max.	1 mm
Basic dynamic load rating - C	23.4 kN
Basic static load rating - C ₀	11.6 kN
Limiting speed	200 r/min
Limiting temperature - T	350 ° C
Category	Single Row Ball Bearings
Inventory	0.0
Manufacturer Name	SKF
Minimum Buy Quantity	N/A
Weight / Kilogram	0.237
EAN	7316571438443



China 608rs Bearing Supplier

Product Group	B00308
Enclosure	2 Metal Shields
Precision Class	ABEC 1 ISO P0
Maximum Capacity / Filling Slot	No
Rolling Element	Ball Bearing
Snap Ring	No
Internal Special Features	Coronet Cage
Cage Material	Graphite
Internal Clearance	C0-Medium
Inch - Metric	Metric
Long Description	25MM Bore; 62MM Outside Diameter; 17MM Outer Race Width; 2 Metal Shields; Ball Bearing; ABEC 1 ISO P0; No Filling Slot; No Snap Ring; Coronet Cage Internal Special Features; C0-Medium Internal Clear
Other Features	Deep Groove Extreme Temperature Variant
Category	Single Row Ball Bearing
UNSPSC	31171504
Harmonized Tariff Code	8482.10.50.68
Noun	Bearing
Keyword String	Ball
Manufacturer URL	http://www.skf.com
Manufacturer Item Number	6305-2Z/VA228
Weight / LBS	0.52
Bore	0.984 Inch 25 Millimeter
Outer Race Width	0.669 Inch 17 Millimeter
Inner Race Width	0 Inch 0 Millimeter
Outside Diameter	2.441 Inch 62 Millimeter
bore diameter:	25 mm



China 608rs Bearing Supplier

precision rating:	Not Rated
outside diameter:	62 mm
finish/coating:	Uncoated
overall width:	17 mm
cage material:	Graphite
bore type:	Round
outer ring width:	17 mm
closure type:	Double Shielded
fillet radius:	1.1 mm
row type & fill slot:	Single Row Non-Fill Slot
maximum rpm:	200 RPM
internal clearance:	C0
series:	63
operating temperature range:	-240 to +660 ° F
resistance features:	Corrosion Resistant, Extreme Temperature
static load capacity:	11.6 kN
d_1	36.6 mm
D_2	52.7 mm
$r_{1,2}$ min.	1.1 mm
d_a min.	32 mm
d_a max.	36.5 mm
D_a max.	55 mm
r_a max.	1 mm
Basic dynamic load rating C	23.4 kN
Basic static load rating C_0	11.6 kN
Limiting temperature T max.	350 ° C
Mass bearing	0.23 kg